

BELC-flow pass heater



Incl. Insulation, suitable for all screw-in radiators of the BELC-heat series up to 7.5kW

Application

For heating heating water, for installation in pipe systems

In the case of service water, the problem of "calcification" must be evaluated

Characteristics

Min. Inlet pressure 0.1 bar [10 kPa], max. Inlet pressure 6.0 bar [600 kPa]

The instantaneous water heater is made of stainless steel V2A [1.4301 / AISI 304]

The insulation is made of Neopor gray RG30 and has an insulation thickness of 20 mm

Warning

The pass water heater must not be put into operation if:

- there is a possibility that the water in the water heater is frozen
- if there is no water in the water heater
- no water flow is available

Type overview:

Type	Order-No.	matching BELC-heat	Length of Install
DLE 530, 1 ½"	012-2533	All Standard Type to 4.5 kW	530 mm
mains water supply: R1" AG			
DLE 740, 1 ½"	012-2535	All Standard Type to 7.5 kW	740 mm
Mains water supply: R 1 ¼" AG			

Technical Specifications

The following information applies to the standard types listed above.
Deviating variants have functionally different data

Scope of application:

for normal water or heating water
other liquids on inquiry

Hot Water Performance

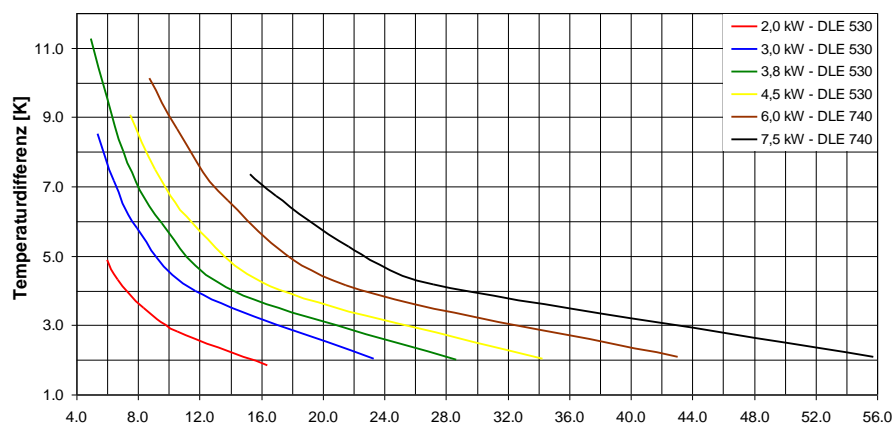

Pressure Loss

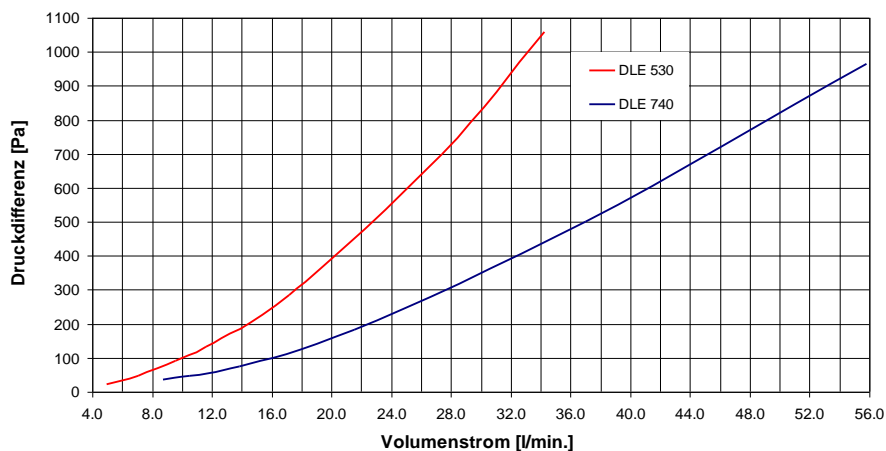

Minimum Volume Flow [l/min.]

Horizontal Installation: (Stratification)

Vertical Installation:

2,0 bis 4,5 kW: 5 l/min.
6,0 kW: 9 l/min.
7,5 kW: 15 l/min.

2,0 bis 4,5 kW: 2 l/min.
6,0 kW: 3 l/min.
7,5 kW: 4 l/min.

Dimensions Drawing

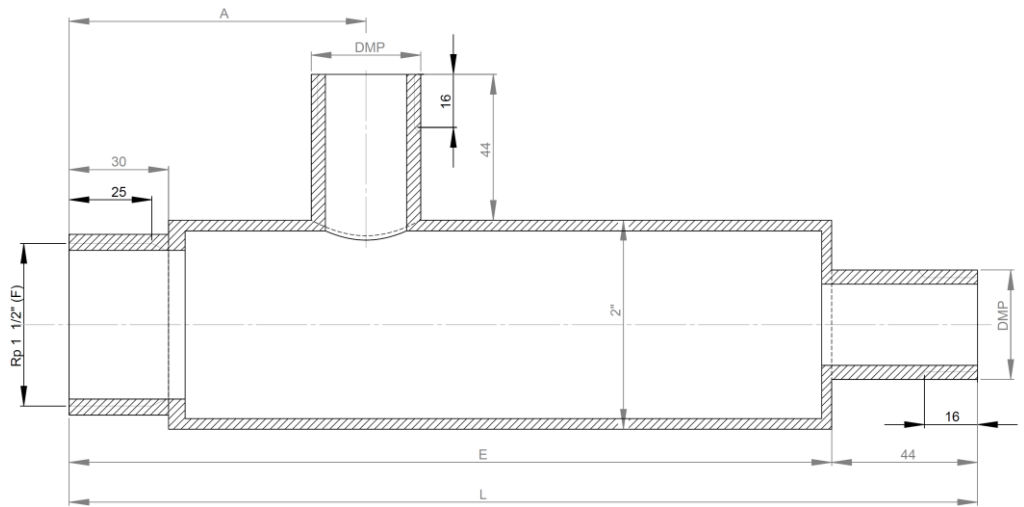

• Typ	DMP	L	E	A
DLE 530	R1"	574	530	76,8mm
DLE 740	R1¼"	784	740	81,2mm

Installation Layout Flow Orientation

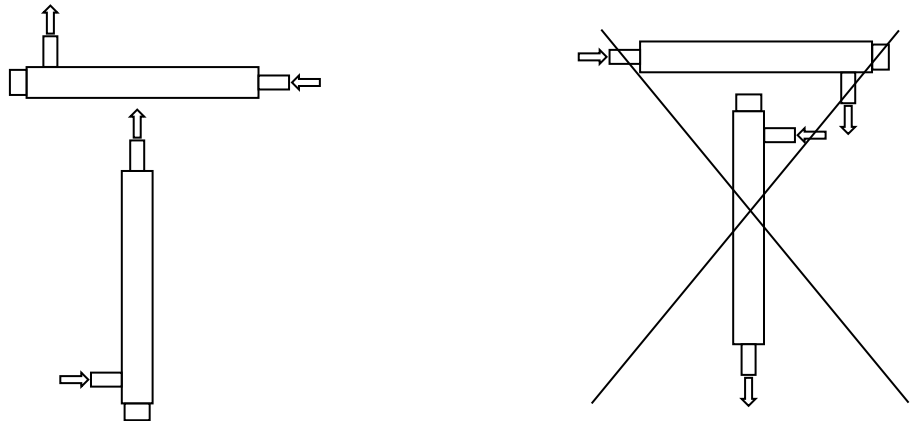

Dimensions Drawing

Assembly Instructions The water outlet must always be at the top so that any air escapes can, see installation positions.

The water heater must not empty itself independently!

In a pipe system, the water heater must be installed at the bottom
When mounting in the area of flammable objects are sufficient large distances or documents from non-combustible materials to assemble